

STATE OF NORTH CAROLINA
DEPARTMENT OF TRANSPORTATION
HIGHWAY DIVISION 6

PLANS

Letting Date: October 16, 2024

CONTRACT ID: DF00496

TIP NO.: -----

FEDERAL AID NO.: STATE FUNDED

WBS ELEMENT NO.: 2025CPT.06.08.20781.1

ROUTE NO.: VARIES

LOCATION: VARIES

COUNTY: ROBESON

LENGTH OF PROJECT: 10.3 MILES

TYPE OF WORK: RESURFACING, MILLING & PAVEMENT MARKINGS

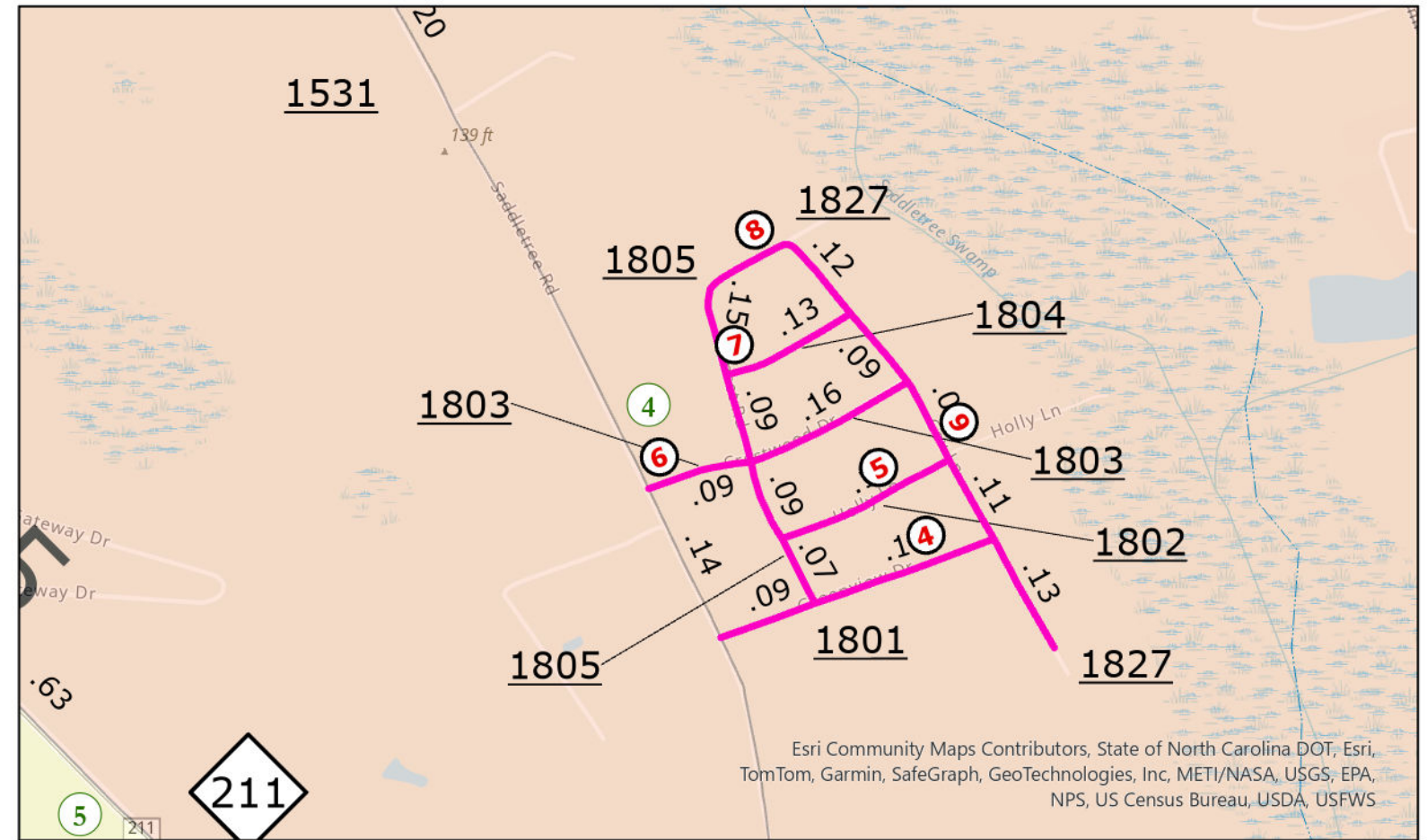
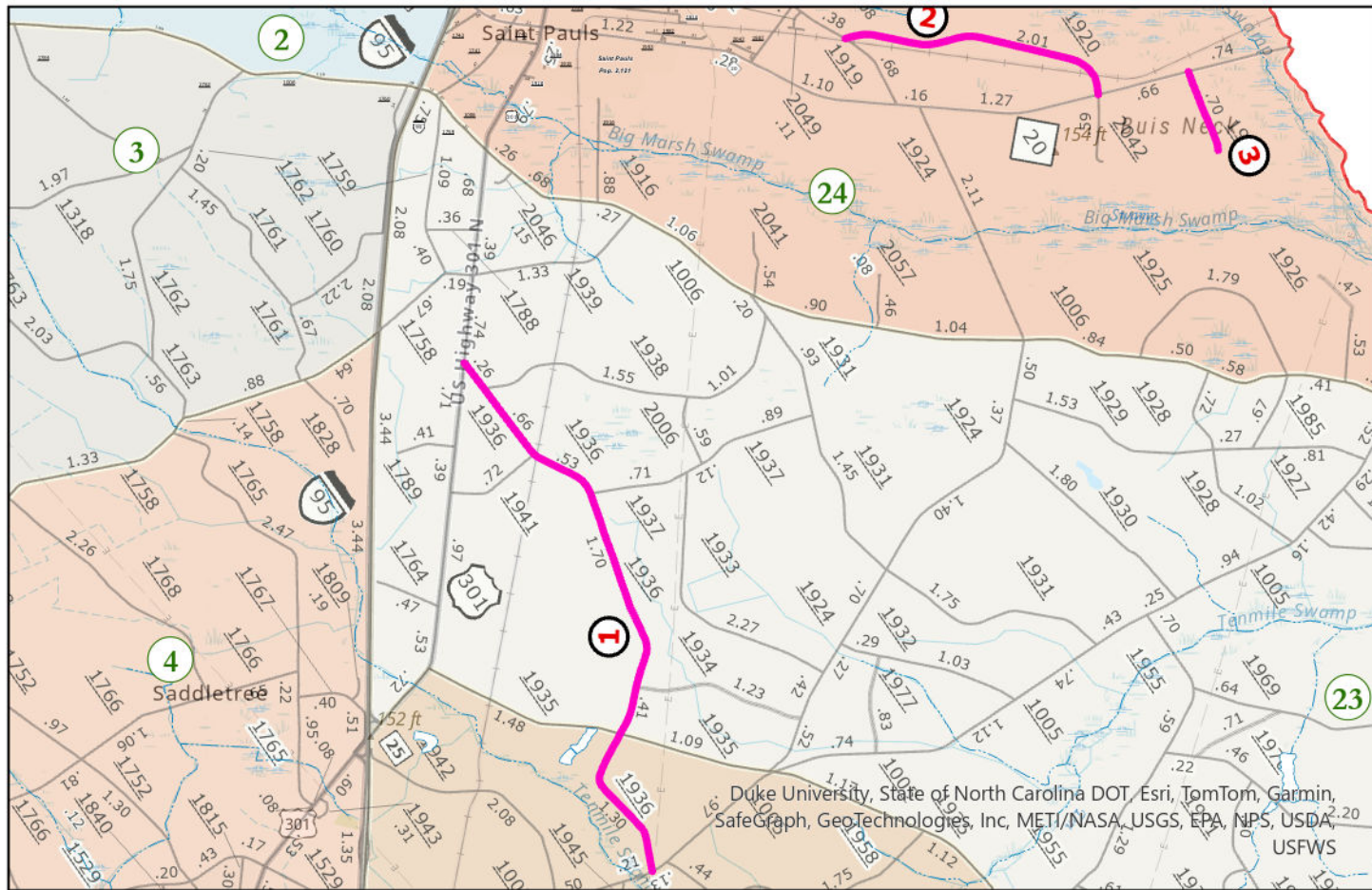

Robeson County Resurfacing, 2025

Contract: DF00496

Legend

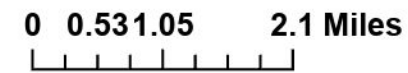

— WBS: 2025CPT.06.08.20781.1

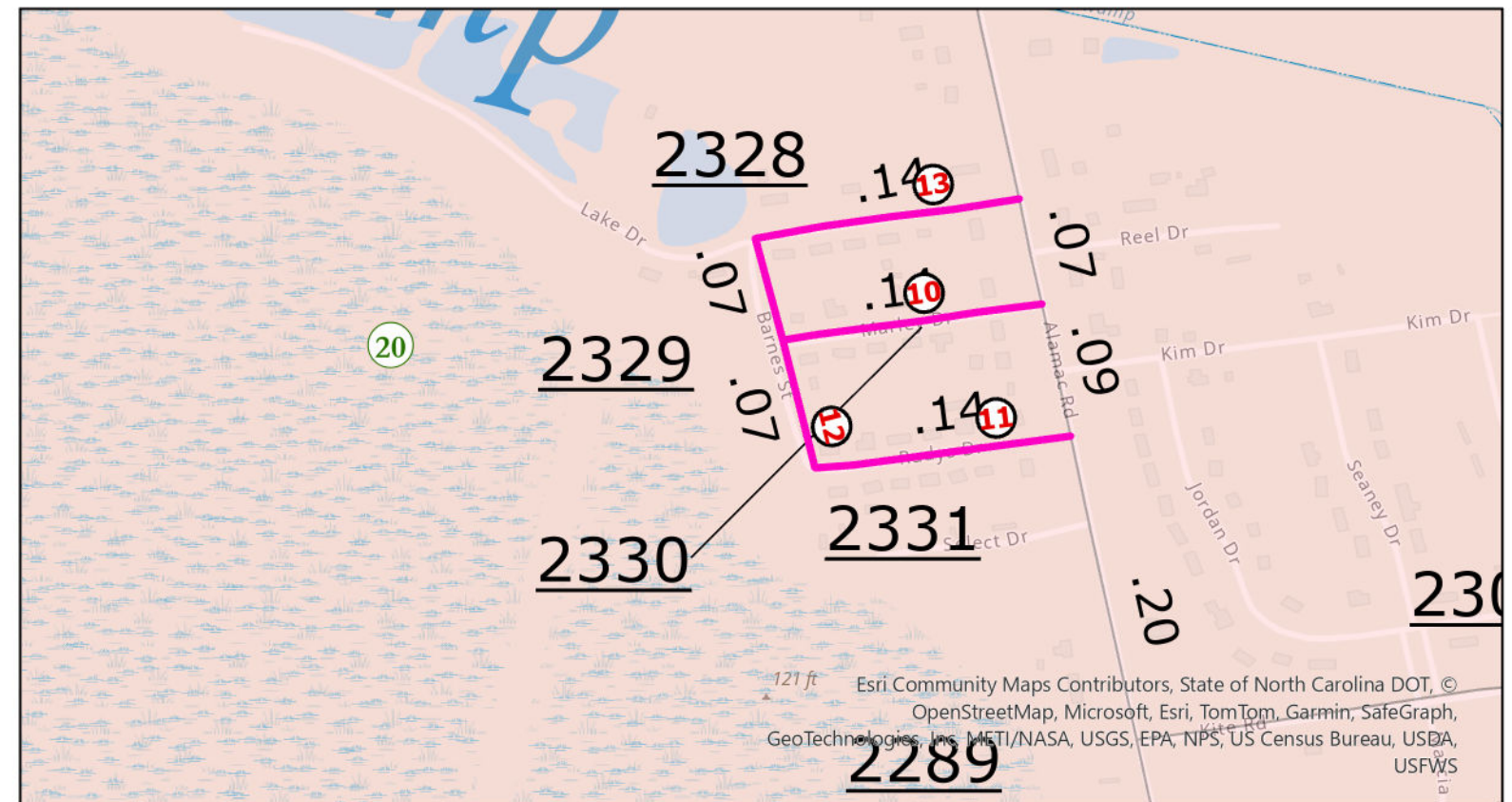
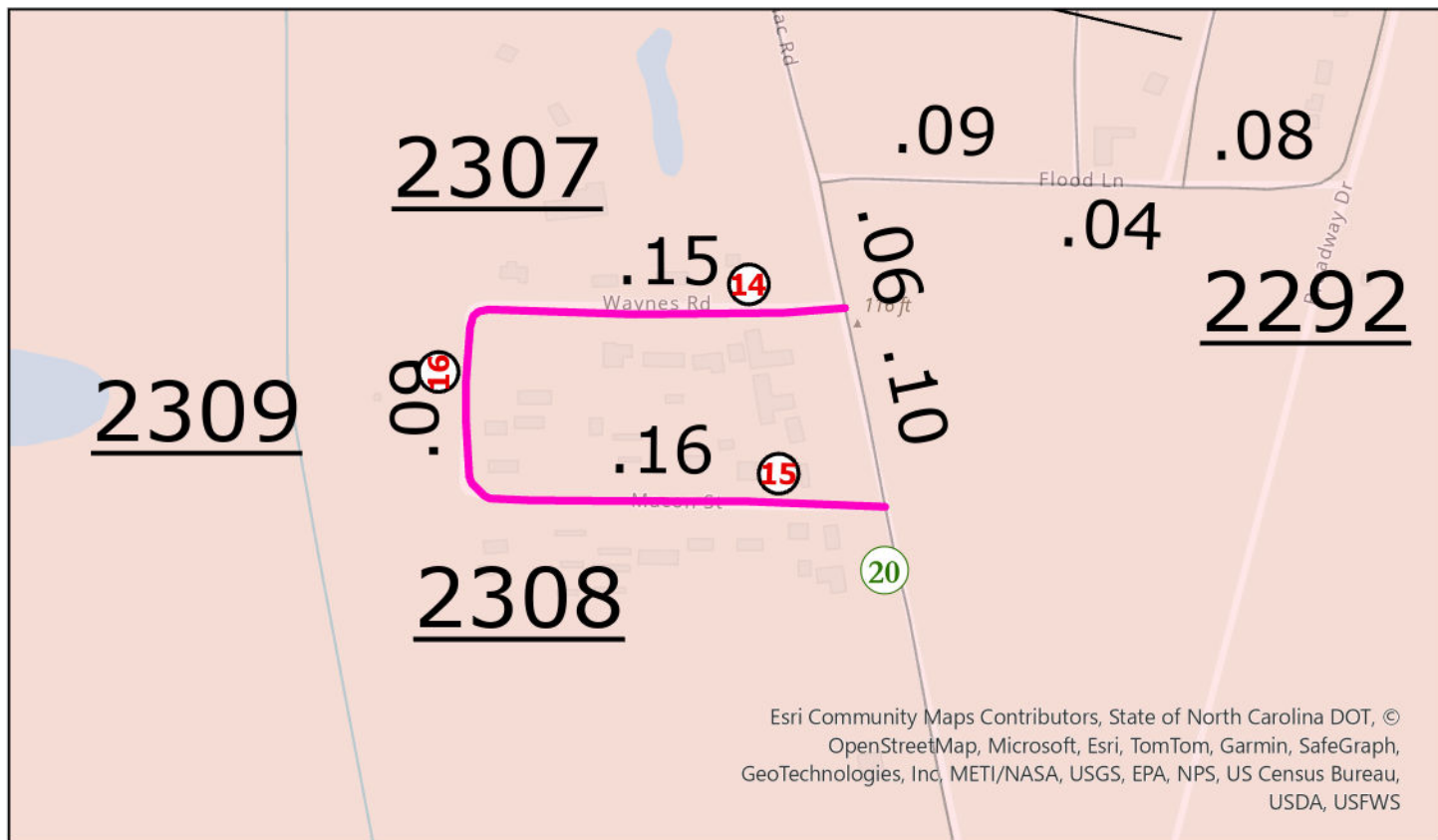

Esri Community Maps Contributors, State of North Carolina DOT, ©
OpenStreetMap, Microsoft, Esri, TomTom, Garmin, SafeGraph,
GeoTechnologies, Inc, METI/NASA, USGS, EPA, NPS, US Census Bureau,
USDA, USFWS

Esri Community Maps Contributors, State of North Carolina DOT, ©
OpenStreetMap, Microsoft, Esri, TomTom, Garmin, SafeGraph,
GeoTechnologies, Inc, METI/NASA, USGS, EPA, NPS, US Census Bureau, USDA,
USFWS

PAVEMENT SCHEDULE	
C1	1" ASPHALT CONCRETE SURFACE COURSE, TYPE S9.5B, AT AN AVERAGE RATE OF 110 LBS. PER SQ. YD.
C2	1½" ASPHALT CONCRETE SURFACE COURSE, TYPE S9.5B, AT AN AVERAGE RATE OF 165 LBS. PER SQ. YD.
E1	5½" ASPHALT CONCRETE BASE COURSE, TYPE B25.0C, AT AN AVERAGE RATE OF 627 LBS. PER SQ. YD.
T1	SHOULDER RECONSTRUCTION WITH AGGREGATE SHOULDER BORROW
U	EXISTING PAVEMENT
V1	0" - 1½" MILLING
V2	1½" MILLING

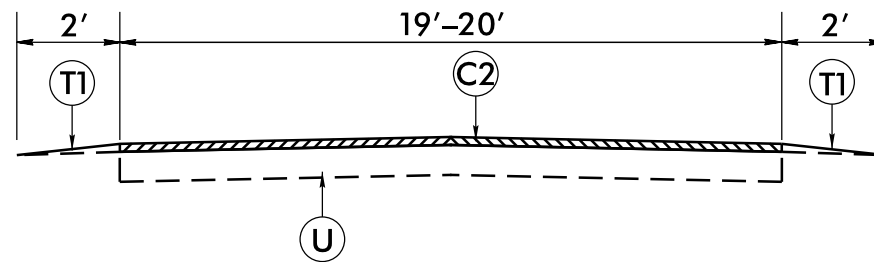

TYPICAL SECTION NO. 1

**PLUS 2' INSIDE CURVE WIDENING (SEE DETAIL)

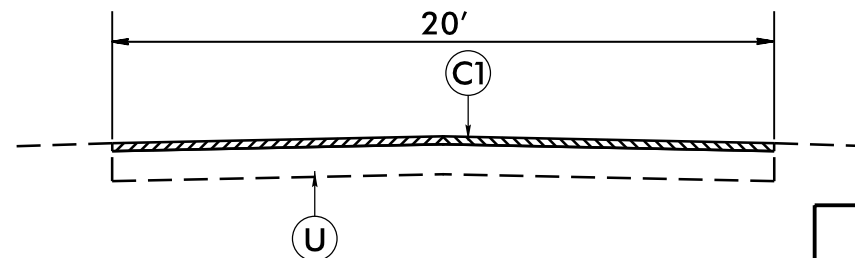

TYPICAL SECTION NO. 2

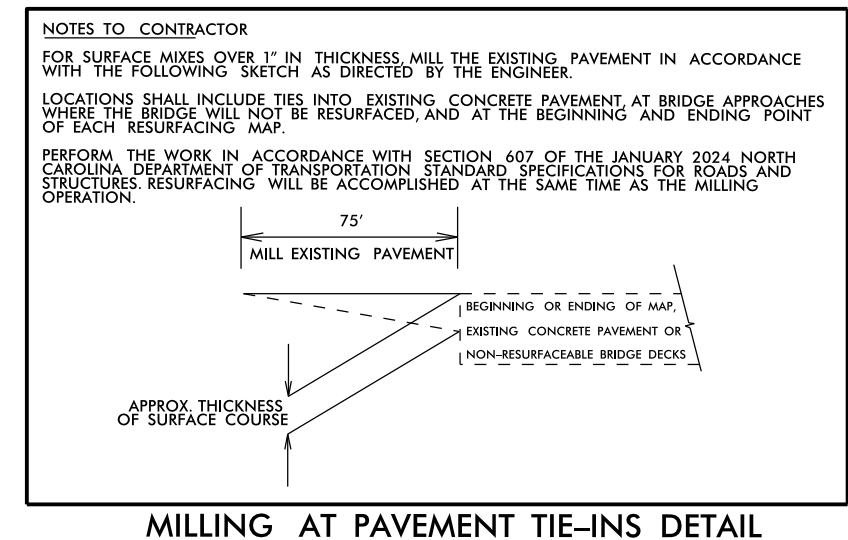
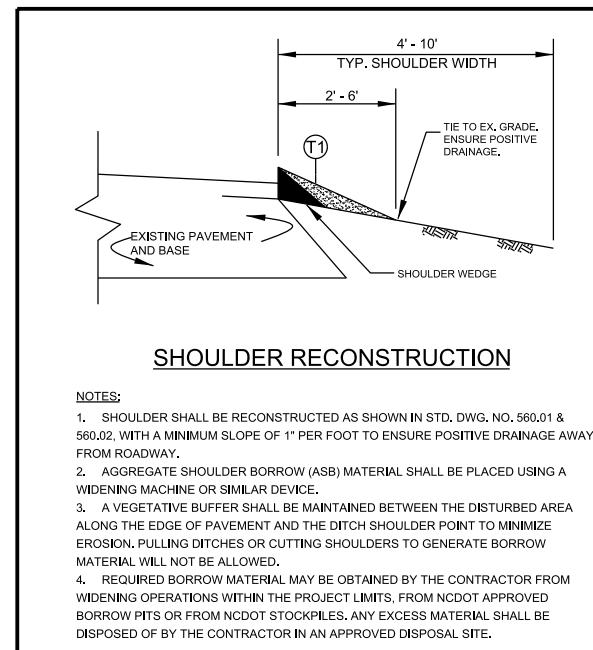
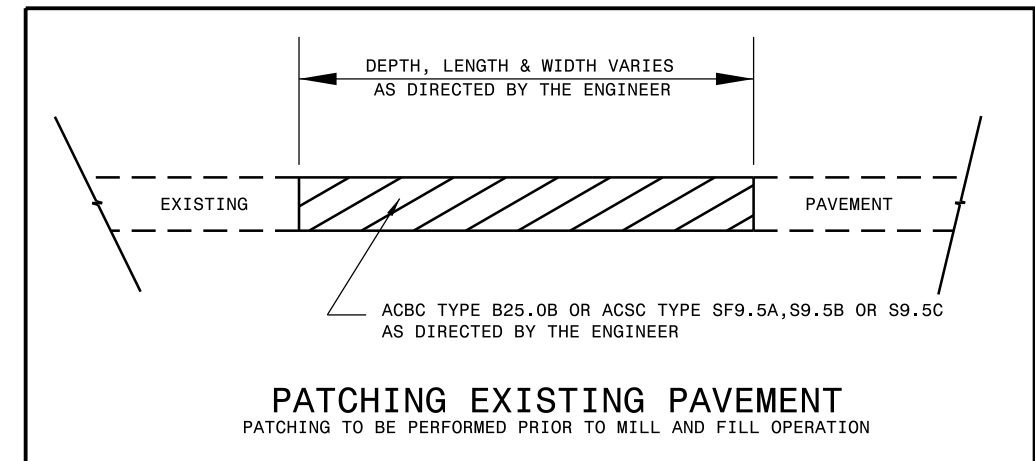
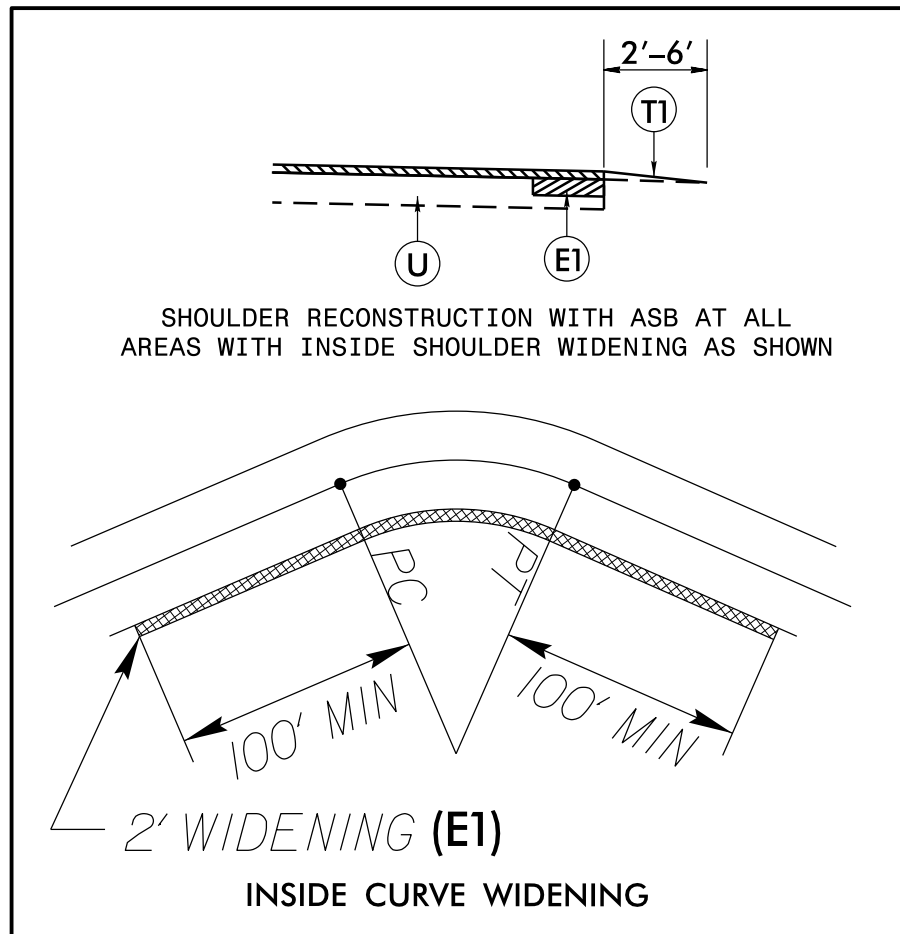
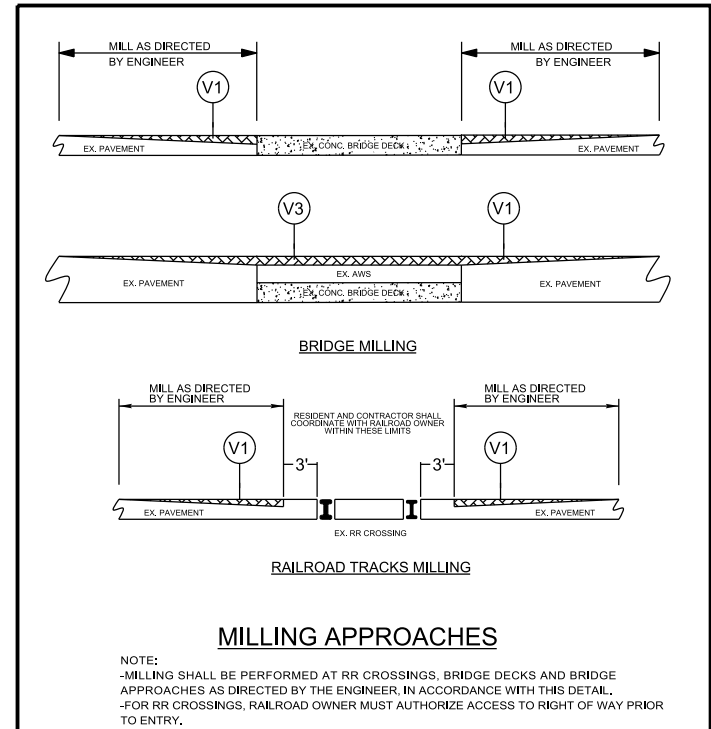

6/2/99
19-SEP-2024 16:51
C:\Users\jg16451\OneDrive\Documents\Projects\DF00496\2025CPT\06.08.20781.1.Fall 2024_Robeson\Plans\TYPICAL.Sdgn

- NOTES:
- 1) DETAIL DOES NOT APPLY TO OGAFB AND ULTRA-THIN BONDED WEARING COURSE.
 - 2) BACKFILL SHOULDER WITH APPROVED MATERIAL.
 - 3) THE SHOULDER WEDGE DEVICE MAY BE DISENGAGED AT PAVED DRIVEWAYS AND SIDE STREETS.

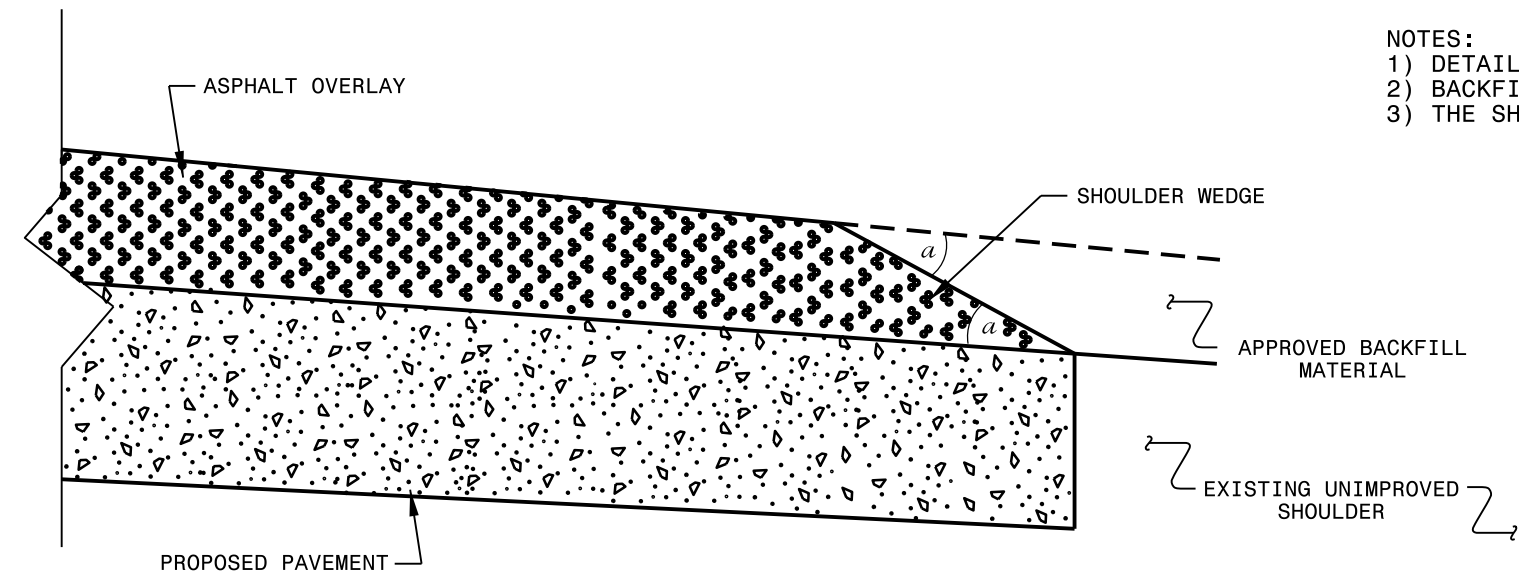

SHOULDER WEDGE DETAIL
 (Resurfacing Projects w/ Widening or
 with Existing Paved Shoulder having no dropoffs)

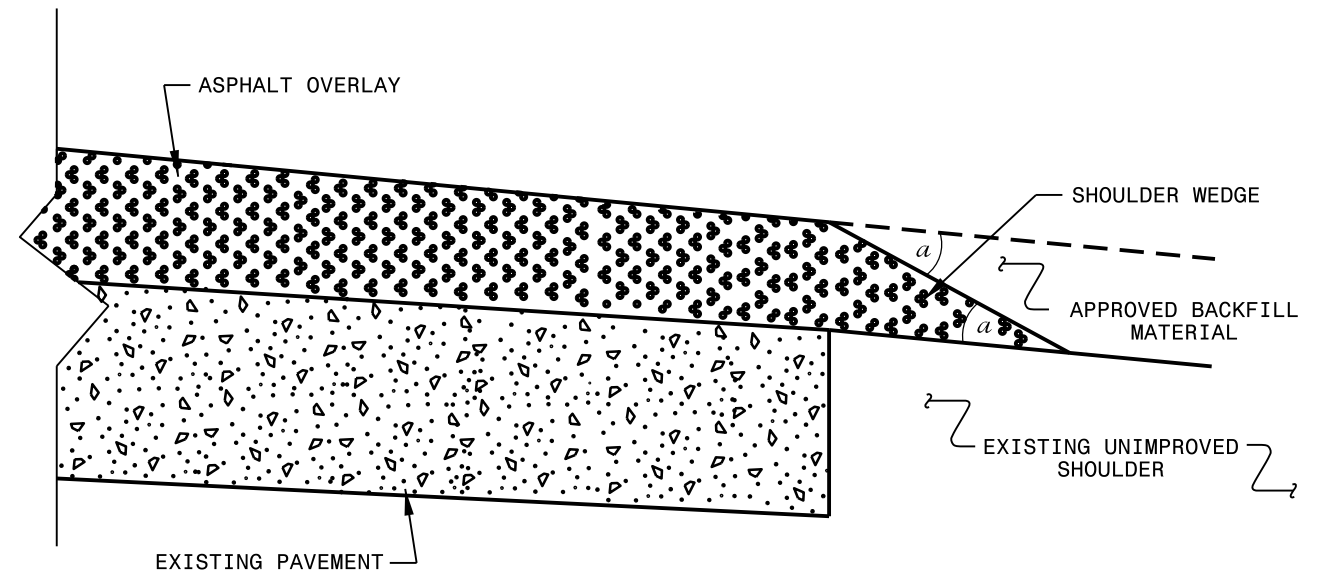

SHOULDER WEDGE DETAIL
 (Resurfacing Projects w/ NO Widening)

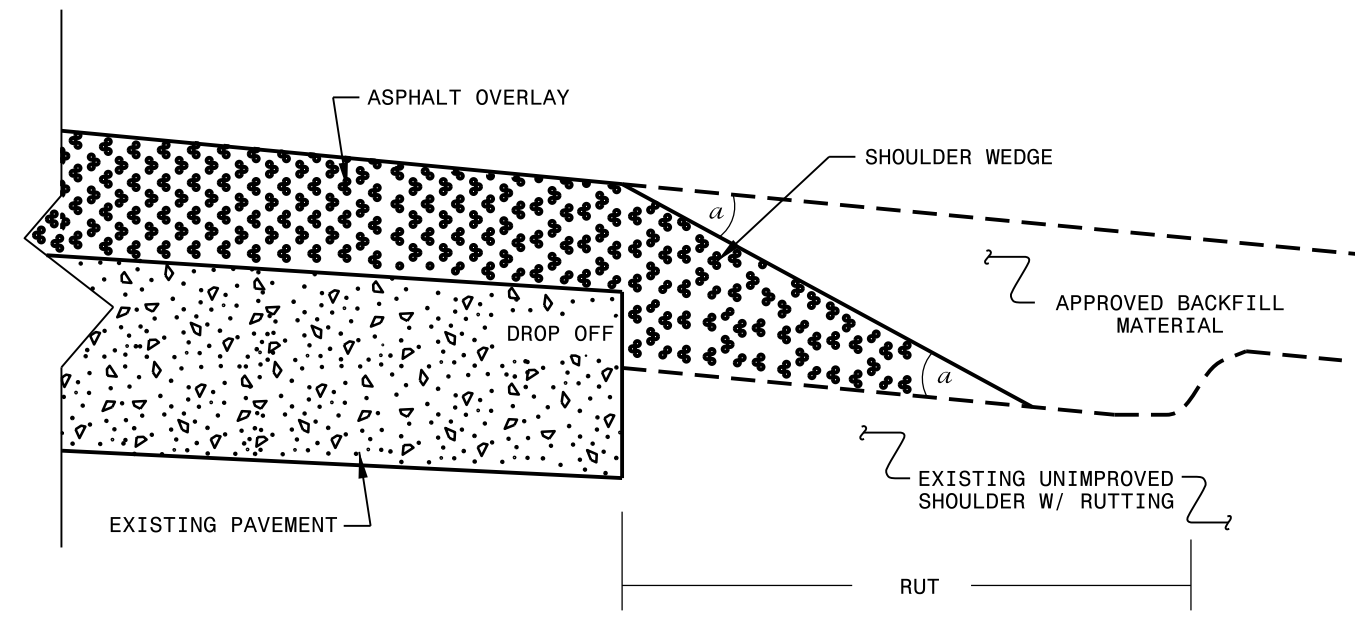

SHOULDER WEDGE DETAIL
 (Resurfacing Adjacent to
 Rutted Shoulder)

- SHOULDER WEDGE ANGLE = 30°

CONTRACT STANDARDS AND DEVELOPMENT UNIT			
Office 919-707-6950		FAX 919-250-4119	
SHOULDER WEDGE DETAILS			
ORIGINAL BY: T.SPELL	DATE: 7-19-11		
MODIFIED BY:	DATE: 10/16/12		
CHECKED BY:	DATE:		
FILE SPEC.: susr/details/stand/shoulderwedgedetail.dgn			

SYSTEM: 11/11/11
 USER: T.SPELL
 FILE: susr/details/stand/shoulderwedgedetail.dgn

SIGNING FOR RESURFACING PROJECTS

LEGEND

┆ STATIONARY SIGN

← DIRECTION OF TRAFFIC FLOW

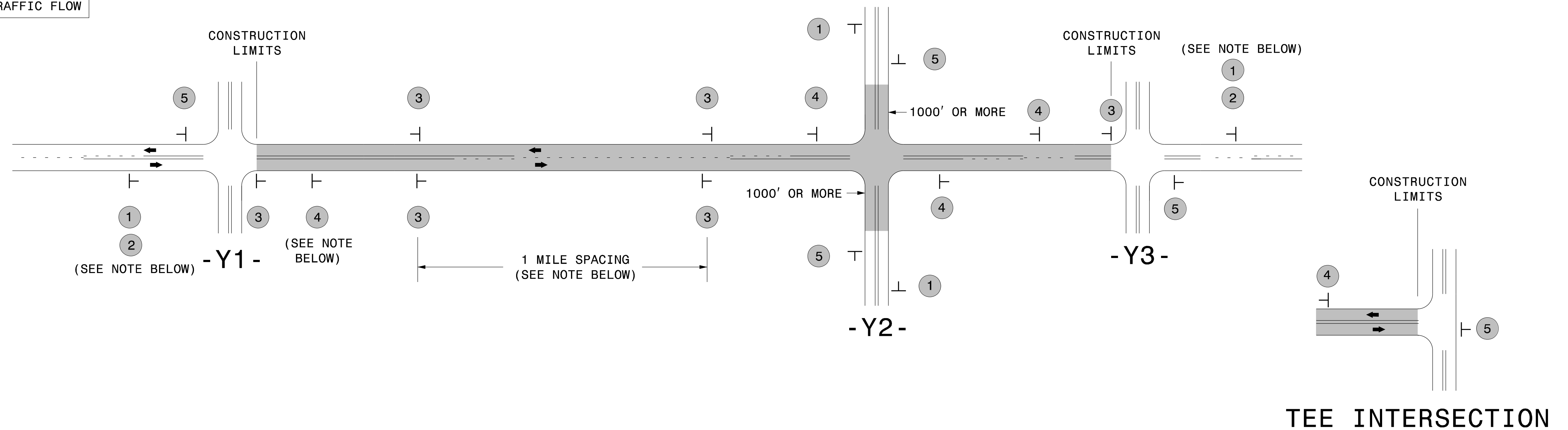

MAINLINE (-L-) SIGNING

-Y- LINE SIGNING

SIGNING NOTES AND PLACEMENT PER DIRECTION	1	 W20-1 48" X 48"	PLACE 1000' PRIOR TO BEGINNING OF CONSTRUCTION LIMITS. ONLY USED ON -Y- LINES IF RESURFACING LIMITS EXTEND 1000' ALONG -Y- LINE.	NO REQUIRED STATIONARY SIGNING FOR THE FOLLOWING -Y- LINE CONDITIONS: 1) LESS THAN 1000' OF RESURFACING ALONG -Y- LINE 2) SUBDIVISION ROADS 3) DEAD END ROADS WHEN PAVING/CONSTRUCTION ACTIVITIES PROCEED ACROSS AN UNSIGNED -Y- LINE, PORTABLE ADVANCE WARNING SIGNS SHALL BE USED ALONG THE -Y- LINE AS SHOWN BELOW. REMOVE UPON COMPLETION OF WORK. <div style="display: flex; justify-content: space-around;"> <div style="text-align: center;"> W20-1 48" X 48" PLACED 500' IN ADVANCE OF FLAGGER. </div> <div style="text-align: center;"> W20-7 A 48" X 48" PLACED 250' IN ADVANCE OF FLAGGER. </div> </div>
	2	 W7-3aP 24" X 18"	#2 SIGN ONLY USED WHEN CONSTRUCTION LIMITS ARE 2 OR MORE MILES IN LENGTH. ROUND UP TO NEXT WHOLE NUMBER. (NO FRACTIONAL OR DECIMAL NUMBERS)	
	3	 SP 13107 48" X 48"	- PLACE INITIALLY AT THE CONSTRUCTION LIMITS AND SPACE 1 MILE APART THEREAFTER. - AT TEE INTERSECTIONS INSTALL INITIALLY 1/2 MILE FROM INTERSECTION AND SPACE 1 MILE APART THEREAFTER.	
	4	 SP 13106 48" X 48"	- THESE ARE FOR -Y- LINES THAT ARE "THROUGH" ROADWAYS. - DEAD END AND SUBDIVISION ROADS ARE NOT "THROUGH" ROADWAYS. - INSTALL 500' +/- FROM EACH -Y- LINE APPROACH AS SHOWN ABOVE. - FOR MULTIPLE -Y- LINES THAT ARE SEPARATED BY 0.25 MILES OR LESS, TREAT AS A SINGLE UNIT AND INSTALL WITHIN 500' OF EACH APPROACH. - A MAXIMUM OF 2 SIGN SETS PER MILE. DO NOT INSTALL WHEN -Y- LINES ARE WITHIN 0.5 MILES FROM "END ROAD WORK" SIGN. - FOR TEE INTERSECTIONS, INSTALL WITHIN 500' +/- OF THE INTERSECTION ALONG -L- LINE.	
	5	 G20-2 A 48" X 24"	PLACE 500' FOLLOWING THE END OF CONSTRUCTION LIMITS OR AS SHOWN WHEN WORK ENDS AT A 3-WAY TEE INTERSECTION.	

THE ABOVE SIGNS ARE ALL THAT ARE REQUIRED FOR A CONTRACTOR TO BEGIN A RESURFACING CONTRACT. ANY ADDITIONAL SIGNS REQUESTED BY NCDOT DIVISIONS SHALL BE INSTALLED WITHIN 7 BUSINESS DAYS OF THE START OF CONTRACT WORK.

MAPS LESS THAN 2 MILES

FOR RESURFACING MAPS WITH CONSTRUCTION LIMITS LESS THAN 2 MILES IN LENGTH, NO STATIONARY SIGNS ARE REQUIRED. USE PORTABLE "ROAD UNDER CONSTRUCTION" OR "ROAD WORK AHEAD" SIGNS IN LIEU OF STATIONARY ADVANCE WARNINGS SIGNS.

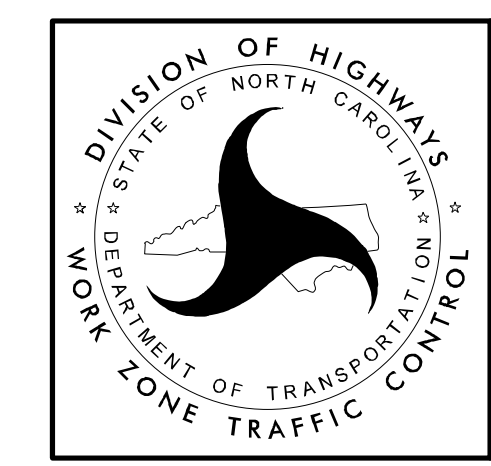

ADVANCE WARNING SIGNS FOR RURAL AND SUBURBAN 2-LANE ROADWAY RESURFACING

GUIDELINES FOR LANE WIDTHS ON RESURFACING PROJECTS

Contractor shall place the new pavement markings in accordance with this table and detail unless otherwise directed by the Engineer.

TWO LANE - TWO WAY ROADWAY - 55 MPH		
ROADWAY WIDTH	LANE WIDTH	SHOULDER WIDTH
18'	9' *	0'
20'	10' *	0'
22'	10'	1'
24'	10'	2'
26'	11'	2'
28'	12'	2'
32'	12'	4'

* May vary due to pavement width

TWO LANE - TWO WAY ROADWAY		50
MPH OR LESS		
ROADWAY WIDTH	LANE WIDTH	SHOULDER WIDTH
18'	9' *	0'
20'	10' *	0'
22'	10'	1'
24'	10'	2'
26'	11'	2'
28'	11'	3'
32'	11'	5'

* May vary due to pavement width

SCHEMATIC OF ROADWAY

(NOT TO SCALE)

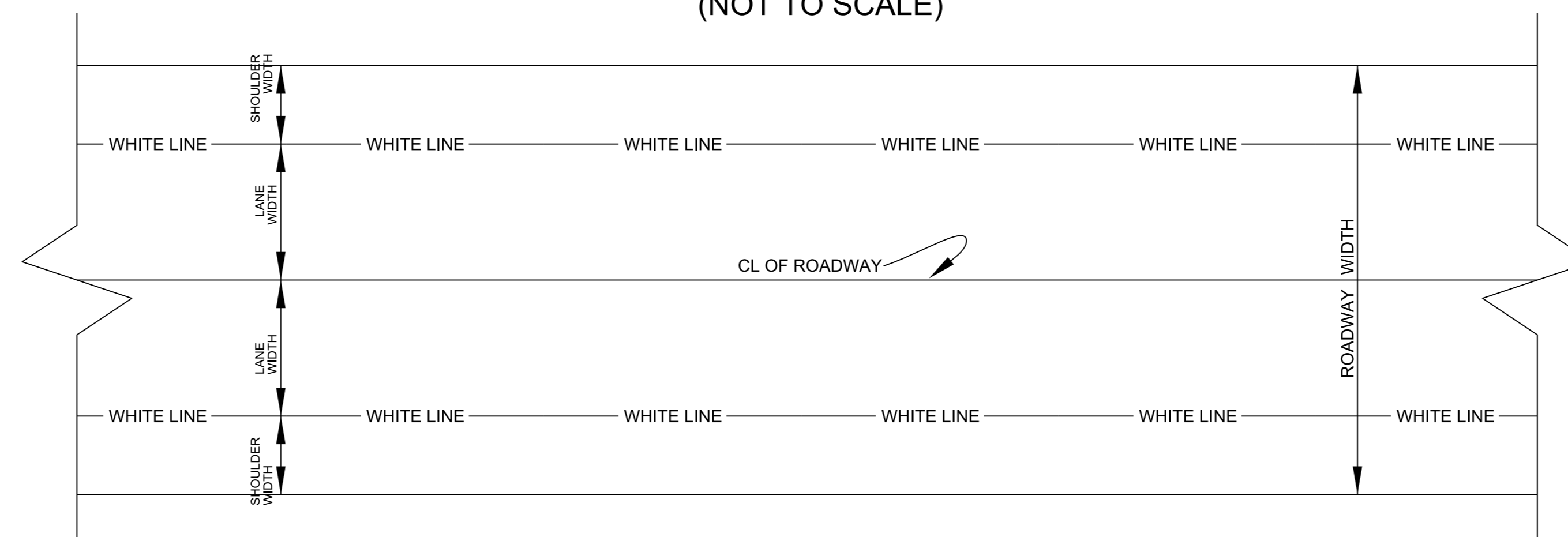

PROJECT NO.	SHEET NO.	TOTAL NO.
2025CPT.06.08.20781.1		

SUMMARY OF QUANTITIES

PROJECT NO	COUNT	MAP NO	ROUTE	DESCRIPTION	TYP NO	LANES	LANE TYPE	LENGTH	WIDTH	BEGIN MP	END MP	0163000000-E	1220000000-E	1245000000-E	1260000000-E	1330000000-E	1491000000-E	1519000000-E	1520000000-E	1575000000-E	1704000000-E	2761000000-E	2845000000-N
												REMOVAL OF EXISTING CONCRETE PAVEMENT	INCIDENTAL STONE BASE	SHOULDER RECONSTRUCTION	AGGREGATE SHOULDER BORROW	INCIDENTAL MILLING	BASE COURSE, B25.0C	SURFACE COURSE, S9.5B	LEVELING COURSE, S9.5B	ASPHALT BINDER FOR PLANT MIX	PATCHING EXISTING PAVEMENT	GENERIC PAVING ITEM - 4" CONCRETE DRIVEWAY	ADJ. OF METER OR VALVE BOX
												SY	TONS	SMI	TON	SY	TONS	TONS	TONS	TONS	TONS	SY	EA
2025CPT.06.08.20781.1	Robeson	1	SR-1936 / ROZIER SIDING RD	FROM US 301 N TO SR 1005	1	2		4.86	19	0	4.86		78	9.72	1,572	2,222	368	4,764	10	338	5		
TOTAL FOR MAP NO. 1													78	9.72	1,572	2,222	368	4,764	10	338	5		
2025CPT.06.08.20781.1	Robeson	2	SR-1920 / BRITT RD	FROM SR 1919 TO NC 20 E	1	2	2WU	2.01	20	0	2.01	56	82	4.02	650	556	352	2,088	10	158	3	56	
TOTAL FOR MAP NO. 2												56	82	4.02	650	556	352	2,088	10	158	3	56	
2025CPT.06.08.20781.1	Robeson	3	SR-1923 / SUTTON RD	FROM NC 20 TO DEAD END	1	2	2WU	0.7	20	0	0.7		17	1.40	226	278		750	10	52	9		
TOTAL FOR MAP NO. 3													17	1.40	226	278		750	10	52	9		
2025CPT.06.08.20781.1	Robeson	4	SR-1801 / GREENVIEW DR	FROM SR 1531 TO SR 1827	2	2	2WU	0.26	20	0	0.26		5					168	10	13	1		
TOTAL FOR MAP NO. 4													5					168	10	13	1		
2025CPT.06.08.20781.1	Robeson	5	SR-1802 / HOLLY LN	FROM SR 1805 TO SR 1827	2	2	2WU	0.17	20	0	0.17		7					110	10	9	1		
TOTAL FOR MAP NO. 5													7					110	10	9	1		
2025CPT.06.08.20781.1	Robeson	6	SR-1803 / CRESTWOOD DR	FROM SR 1531 TO SR 1827	2	2	2WU	0.26	20	0	0.26		5					168	10	13	2		
TOTAL FOR MAP NO. 6													5					168	10	13	2		
2025CPT.06.08.20781.1	Robeson	7	SR-1804 / EDGEWOOD DR	FROM SR 1805 TO SR 1827	2	2	2WU	0.13	20	0	0.13		2					84	10	8	1		
TOTAL FOR MAP NO. 7													2					84	10	8	1		
2025CPT.06.08.20781.1	Robeson	8	SR-1805 / SUNSET RD	FROM SR 1801 TO SR 1827	2	2	2WU	0.42	20	0	0.42		13					271	10	20	3		
TOTAL FOR MAP NO. 8													13					271	10	20	3		
2025CPT.06.08.20781.1	Robeson	9	SR-1827 / COXS LN	FROM SR 1827 TO CUL-DE-SAC	2	2	2WU	0.52	20	0	0.52		27					375	10	28	16		
TOTAL FOR MAP NO. 9													27					375	10	28	16		
2025CPT.06.08.20781.1	Robeson	10	SR-2330 / MARLEY DR	FROM SR 2289 TO SR 2329	2	2	2WU	0.14	20	0	0.14							90	10	8	2		
TOTAL FOR MAP NO. 10																		90	10	8	2		
2025CPT.06.08.20781.1	Robeson	11	SR-2331 / RUDYS DR	FROM SR 2289 TO SR 2329	2	2	2WU	0.14	20	0	0.14		7					97	10	8	4		1
TOTAL FOR MAP NO. 11													7					97	10	8	4		1
2025CPT.06.08.20781.1	Robeson	12	SR-2329 / CHIMNEY DR	FROM SR 2328 TO SR 2331	2	2	2WU	0.15	20	0	0.15		3					97	10	8	1		
TOTAL FOR MAP NO. 12													3					97	10	8	1		
2025CPT.06.08.20781.1	Robeson	13	SR-2328 / LAKE DR	FROM SR 2289 TO SR 2329	2	2	2WU	0.14	20	0	0.14		8					90	10	8	2		1
TOTAL FOR MAP NO. 13													8					90	10	8	2		1
2025CPT.06.08.20781.1	Robeson	14	SR-2307 / MONROE ST	FROM SR 2289 TO SR 2309	2	2	2WU	0.15	20	0	0.15		10					97	10	8	1		2
TOTAL FOR MAP NO. 14													10					97	10	8	1		2
2025CPT.06.08.20781.1	Robeson	15	SR-2308 / MACON ST	FROM SR 2289 TO SR 2309	2	2	2WU	0.16	20	0	0.16		17					103	10	9	5		2
TOTAL FOR MAP NO. 15													17					103	10	9	5		2
2025CPT.06.08.20781.1	Robeson	16	SR-2309 / MONROE ST	FROM SR 2308 TO SR 2307	2	2	2WU	0.09	20	0	0.09		3					58	10	6	1		
TOTAL FOR MAP NO. 16													3					58	10	6	1		
TOTAL FOR PROJ NO. 2025CPT.06.08.20781.1												56	284	15.14	2,448	3,056	720	9,410	160	694	57	56	6
GRAND TOTAL												56	284	15.14	2,448	3,056	720	9,410	160	694	57	56	6

PROJECT NO.	SHEET NO.	TOTAL NO.
2025CPT.06.08.20781.1		

THERMOPLASTIC AND PAINT QUANTITIES

PROJECT NO	COUNT	MAP NO	ROUTE	DESCRIPTION	TYP NO	LANES	LANE TYPE	LENGTH	WIDTH	BEGIN MP	END MP	4413000000-E	4457000000-N	4685000000-E		4709000000-E	4891000000-E		4892000000-N	4900000000-N	
												WORK ZONE ADVANCE/GENERAL WARNING SIGNING	TEMPORARY TRAFFIC CONTROL	4" X 90 M WHITE THERMO	4" X 90 M YELLOW THERMO	24" X 90 M WHITE THERMO	GENERIC MARKING, 16" X 90 M WHITE THERMO(RXR CROSSBUCK)	GENERIC MARKING, 24" X 90 M WHITE THERMO	GENERIC MARKING, THERMO RXR 90 M	YELLOW & YELLOW MARKERS	
								MI	FT			SF	LS	LF	LF	LF	LF	LF	EA	EA	
2025CPT.06.08.20781.1	Robeson	1	SR-1936 / ROZIER SIDING RD	FROM US 301 N TO SR 1005	1	2		4.86	19	0	4.86	544	1.00	51,322	43,623	20	100	40	4	321	
TOTAL FOR MAP NO. 1								4.86				544	1	51,322	43,623	20	100	40	4	321	
2025CPT.06.08.20781.1	Robeson	2	SR-1920 / BRITT RD	FROM SR 1919 TO NC 20 E	1	2	2WU	2.01	20	0	2.01	225		21,226	18,042	20	100	50	4	133	
TOTAL FOR MAP NO. 2								2.01				225		21,226	18,042	20	100	50	4	133	
2025CPT.06.08.20781.1	Robeson	3	SR-1923 / SUTTON RD	FROM NC 20 TO DEAD END	1	2	2WU	0.7	20	0	0.7	78									
TOTAL FOR MAP NO. 3								0.7				78									
2025CPT.06.08.20781.1	Robeson	4	SR-1801 / GREENVIEW DR	FROM SR 1531 TO SR 1827	2	2	2WU	0.26	20	0	0.26	29									
TOTAL FOR MAP NO. 4								0.26				29									
2025CPT.06.08.20781.1	Robeson	5	SR-1802 / HOLLY LN	FROM SR 1805 TO SR 1827	2	2	2WU	0.17	20	0	0.17	19									
TOTAL FOR MAP NO. 5								0.17				19									
2025CPT.06.08.20781.1	Robeson	6	SR-1803 / CRESTWOOD DR	FROM SR 1531 TO SR 1827	2	2	2WU	0.26	20	0	0.26	29									
TOTAL FOR MAP NO. 6								0.26				29									
2025CPT.06.08.20781.1	Robeson	7	SR-1804 / EDGEWOOD DR	FROM SR 1805 TO SR 1827	2	2	2WU	0.13	20	0	0.13	15									
TOTAL FOR MAP NO. 7								0.13				15									
2025CPT.06.08.20781.1	Robeson	8	SR-1805 / SUNSET RD	FROM SR 1801 TO SR 1827	2	2	2WU	0.42	20	0	0.42	47									
TOTAL FOR MAP NO. 8								0.42				47									
2025CPT.06.08.20781.1	Robeson	9	SR-1827 / COXS LN	FROM SR 1827 TO CUL-DE-SAC	2	2	2WU	0.52	20	0	0.52	47									
TOTAL FOR MAP NO. 9								0.52				47									
2025CPT.06.08.20781.1	Robeson	10	SR-2330 / MARLEY DR	FROM SR 2289 TO SR 2329	2	2	2WU	0.14	20	0	0.14	16									
TOTAL FOR MAP NO. 10								0.14				16									
2025CPT.06.08.20781.1	Robeson	11	SR-2331 / RUDYS DR	FROM SR 2289 TO SR 2329	2	2	2WU	0.14	20	0	0.14	16									
TOTAL FOR MAP NO. 11								0.14				16									
2025CPT.06.08.20781.1	Robeson	12	SR-2329 / CHIMNEY DR	FROM SR 2328 TO SR 2331	2	2	2WU	0.15	20	0	0.15	17									
TOTAL FOR MAP NO. 12								0.15				17									
2025CPT.06.08.20781.1	Robeson	13	SR-2328 / LAKE DR	FROM SR 2289 TO SR 2329	2	2	2WU	0.14	20	0	0.14	16									
TOTAL FOR MAP NO. 13								0.14				16									
2025CPT.06.08.20781.1	Robeson	14	SR-2307 / MONROE ST	FROM SR 2289 TO SR 2309	2	2	2WU	0.15	20	0	0.15	17									
TOTAL FOR MAP NO. 14								0.15				17									
2025CPT.06.08.20781.1	Robeson	15	SR-2308 / MACON ST	FROM SR 2289 TO SR 2309	2	2	2WU	0.16	20	0	0.16	18									
TOTAL FOR MAP NO. 15								0.16				18									
2025CPT.06.08.20781.1	Robeson	16	SR-2309 / MONROE ST	FROM SR 2308 TO SR 2307	2	2	2WU	0.09	20	0	0.09	10									
TOTAL FOR MAP NO. 16								0.09				10									
TOTAL FOR PROJ NO. 2025CPT.06.08.20781.1								10.3				1,143	1.000	72,548	61,665	40	200	90	8	454	
														134,213		290					
GRAND TOTAL								10.3				1,143	1.000	72,548	61,665	40	200	90	8	454	
														134,213		290					